

Enapter ENP-RS232-MPP Datasheet



RS-232-MPP Module

The RS-232-MPP Module monitor and manage MPP Solar Inverters with RS-232 port and Watchpower Serial Protocol. It sends the collected data to the Enapter Gateway and Cloud via secure wireless connection. The RS-232-MPP Module is based on Enapter RS-232 Module.

Dimensions

The dimensions are in mm and in brackets in inch.

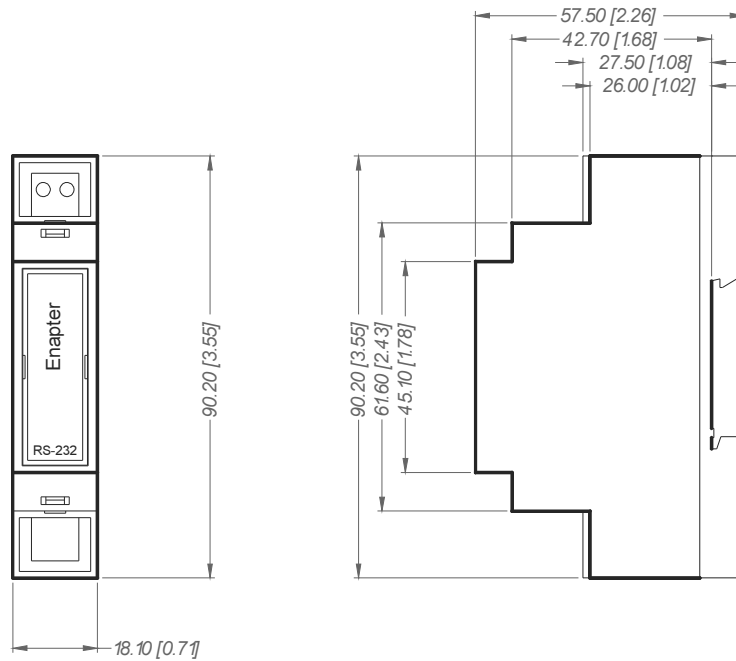

Mounting

ENP-RS232-MPP Module must be horizontally mounted on 35 mm DIN rail according to IEC 60715.

Correct Mounting Position

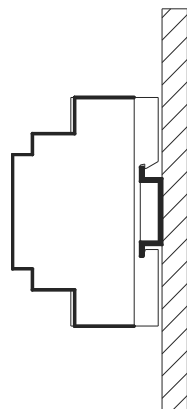

Incorrect Mounting Position

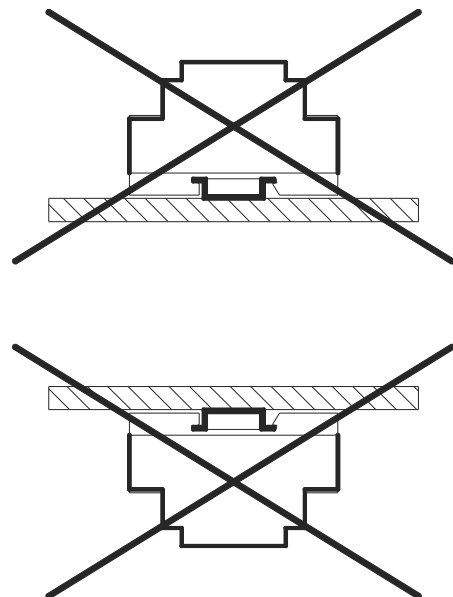

Connection Example

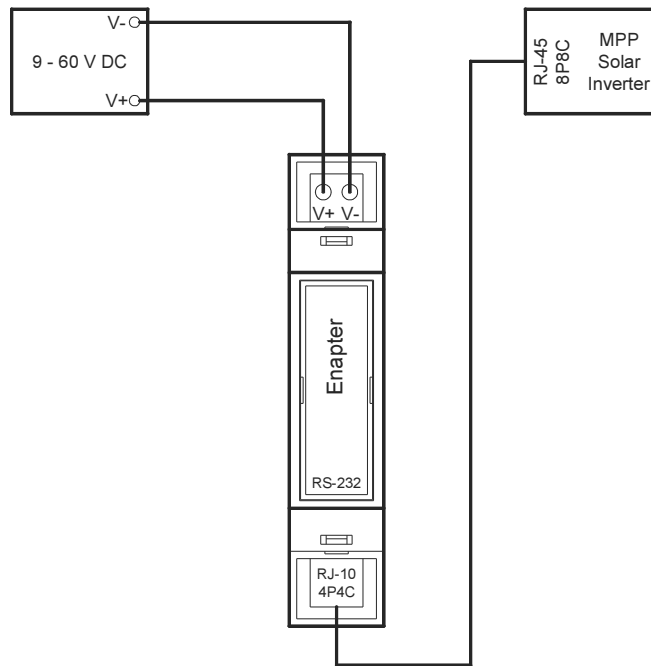

Note: 1 Amp Circuit Breaker recommended to use on power line for the ENP-RS232-MPP Module.

Connection Cable Pinout

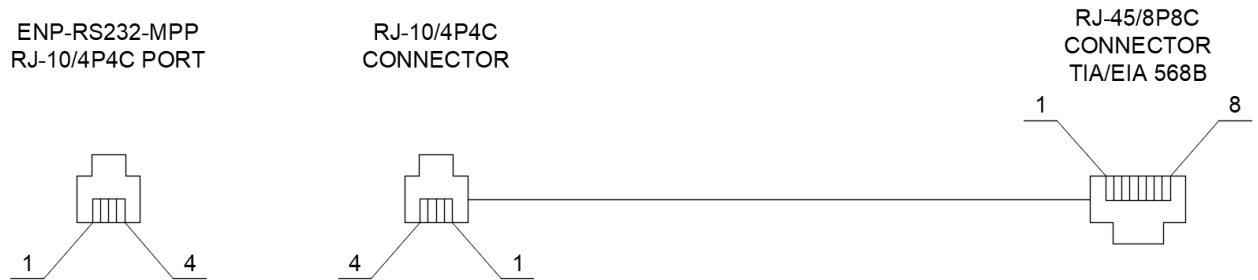

RJ-10/4P4C CONNCECTOR		Wire Color	RJ-45/8P8C CONNECTOR	
2	Tx	White/orange stripe	Rx	1
1	Rx	Orange solid	Tx	2
		White/green stripe	Not used	3
		Blue solid	Not used	4
		White/blue stripe	Not used	5
		Green solid	Not used	6
3	Not used	White/brown stripe	Not used	7
4	Gnd	Brown solid	Gnd	8

Standards

Wi-Fi protocols – 802.11 b/g/n/e/i (802.11n up to 150 Mbit/s).

Bluetooth protocols – Bluetooth v4.2 BR/EDR and BLE specification.



Alternating current voltage of 220V / 110V is potentially lethal!



All works on assembly and installation should be performed only with a disconnected power supply!



The installation and assembly of electrical equipment must be carried out by electrically qualified persons.